

## HVAC INSULATION

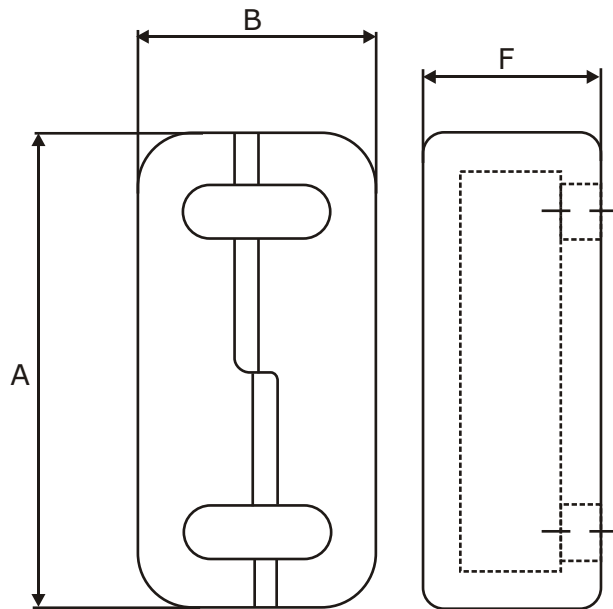

SWEP offers a wide range of Compact Brazed Heat exchangers (CBEs) for many demanding applications worldwide. SWEP's CBEs are complemented with a comprehensive range of accessories including stud bolts, support legs, counter connections, insulation and much more. This product sheet describes our HVAC insulation boxes for heating applications.

# HVAC INSULATION



## DIMENSIONS

Size	5	8	10/12	15	16
A mm	242	385	360	530	452
B mm	116	122	183	126	185
F mm* approx.	66,0+2,5xNP	66,0+2,5xNP	84,0+2,4xNP	66,0+2,5xNP	85,0+2,25xNP
Thickness mm	20	25	30	25	30

\*Only available in selected 10th NP (for example 10, 20, 30, etc). NP = Number of Plates

Size	25/28/80	35	45	50	56
A mm	599	495	627	627	627
B mm	183	330	330	330	330
F mm* approx.	84,3+2,4xNP	105,1+2,4xNP	105,1+2,4xNP	105,1+2,4xNP	105,1+2,4xNP
Thickness mm	30	40	40	40	40

\*Only available in selected 10th NP (for example 10, 20, 30, etc). NP = Number of Plates

Size	65	427
A mm	1050	850
B mm	477	418
F mm* approx.	178,0+2,4xNP	154,5+2,3xNP
Thickness mm	60	60

\*Only available in selected 10th NP (for example 10, 20, 30, etc). NP = Number of Plates

## TECHNICAL DATA

Max working temperature	130°C
Color	Burgundy red RAL3009

## MATERIAL

Insulation:	Rigid expanded polyurethane
Insulation cover:	Polystyrene 475K

## SWEP ACCESSORIES

HVAC insulation boxes have been developed mainly for use in heating applications at up to 130°C, and are available for most CBEs. Fitting the insulation box to the CBE is quick and easy.



SWEP accessories meet the same high standards as the company's CBEs. They are produced according to SWEP's specification by rigorously selected suppliers. The high-quality materials are carefully chosen for compatibility, while the accurate dimensions save you time and money on installation. With SWEP accessories you have the assurance that everything will fit and perform the way the design engineers intended.

For more information, please contact your local SWEP representative or visit [www.swep.net](http://www.swep.net)

For additional information please contact your local SWEP representative. SWEP reserves the right to make changes without prior notice

Copyright SWEP



## SWEP INTERNATIONAL AB

Box 105, SE-261 22 Landskrona, Sweden  
 Phone +46 418 40 04 00  
 Fax +46 418 292 95  
 Internet: [www.swep.net](http://www.swep.net)  
 E-mail: [info@swep.net](mailto:info@swep.net)